

DATA SHEET

KIO-LITE156P-AUR

COUNTERTOP KIOSK

The InTouch KIO-LITE-156-AUR 15.6" portrait kiosk is a compact countertop unit perfect for self-service QSR and retail stores. The base is designed to neatly house a thermal label printer, making this kiosk a perfect solution for customers to self-order and pay.

Built to industrial standards, the kiosk's clever modular design can incorporate a thermal receipt printer, a QR code + barcode scanner and has the ability to add a bracket for your EFTPOS terminal. All of which are compactly and securely integrated. The robust steel constructed stand is finished with a durable powder-coat finish and the touch screen boasts toughened glass that can withstand high-traffic public spaces. Conveniently, the edge-to-edge glass allows for an easy, regular cleaning regime with isopropyl or sterilising wipes.



KIOSK FEATURES

- Australian designed, manufactured and supported
- Neat cable management for a tidy presentation
- Clever modular design allows addition of multiple peripherals
- Issue customers with a receipt in an instant with the compact thermal printer
- 3 Year Warranty
- Minimum order quantities apply

INDUSTRIAL DISPLAY BUILT FOR TOUCH

- 15.6" commercial-grade touch screen in portrait
- Projected capacitive (PCAP) 10-point multi-touch

- Full HD 1080 x 1920 (9:16 aspect ratio)
- Edge-to-edge glass with a silver trim
- High clarity display with protective toughened glass
- Windows 10 compatible, driver free, plug-and-play
- Supports multi-touch gestures including swipe, pinch & zoom

OPTIONAL PERIPHERAL ADD ONS

- 2D Barcode scanner / QR Code Reader
- HD Camera
- BYO Eftpos terminal
- Thermal receipt printer
- Mini PC



AUSTRALIAN MADE



3-YEAR WARRANTY



10 POINT MULTI-TOUCH



EASY SET UP

KIO-LITE-156P-AURES - Other Configurations

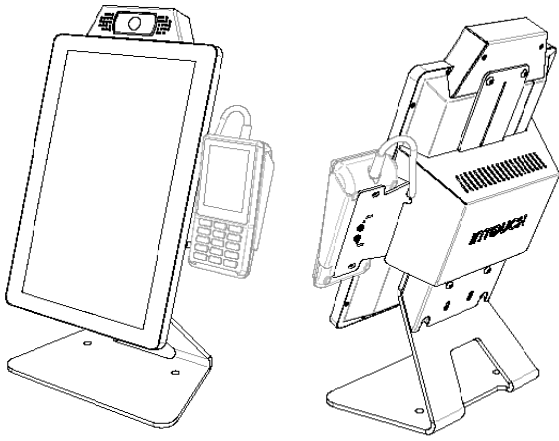

Option 1: Standard base plate + EFTPOS* bracket + fixed or tilt adjustable HD Camera

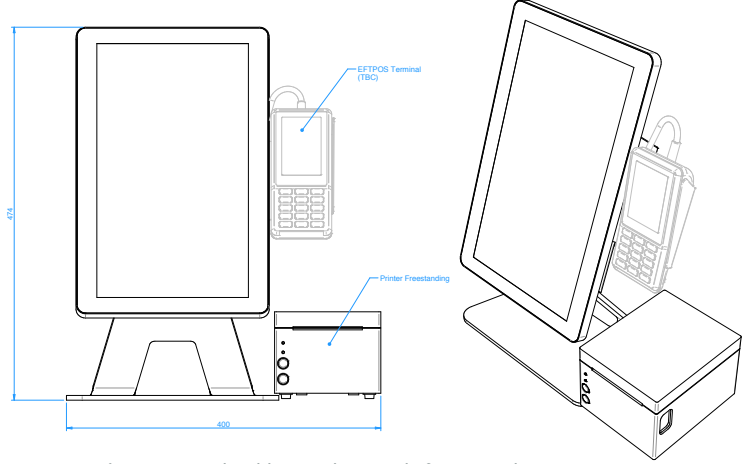

Option 2: Standard base plate with freestanding thermal printer + EFTPOS* bracket

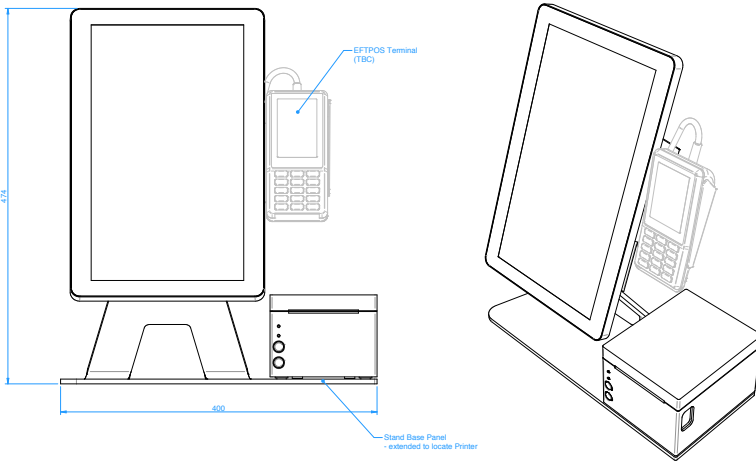

Option 3: Extended base plate to accommodate thermal printer + EFTPOS* bracket

* EFTPOS terminal not included

Kiosk Options

- 2D Barcode scanner
- Kiosk Mini PC
- HD Camera
- Thermal receipt printer
- EFTPOS mounting bracket

Technical Specifications

- 1080 x 1920 Full HD resolution
- 15.6" active viewable area
- 300cd/m2 brightness
- 800:1 contrast ratio
- 5ms response time
- 10-point multi-touch (PCAP)
- 50,000 MTBF Long-life Screen
- Powder-coated steel body
- Toughened glass touch surface
- Multi-touch gesture support
- Internal cable management
- Compatible with Windows 10
- PC sold separately
- Weight 12.28kg (with all peripherals)

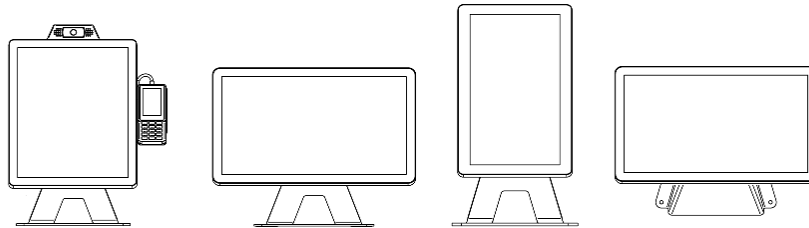

Our interactive KIO-LITE Kiosks are available in sizes from 15.6" - 22" to suit any application and available installation space.

InTouch Screens

Unit 1, 3 Green Street, Brookvale NSW 2100
1300 557 219

InTouchScreens.com.au | Sales@intouchscreens.com.au

INTOUCH